

MANUKAU OFFICE FOR LEASE

JUNE 2018

- ADDRESS:** 8 Sharkey Street, corner 7 Ronwood Ave, Manukau City
- DESCRIPTION:** Ground floor office tenancy very close to the heart of Manukau. Prominent exclusive front entry with canopy and wind lobby. Good quality rectangular shaped tenancy, air conditioned, sprinklered, and separate rear entry with roller door if required. Multiple carparks available on site.
- LEGAL DESCRIPTION:** Part of Lot1 DP 196444 (NA124C/522), part of 7,348 sqm corner site
- TENURE:** Freehold to Lewis Holdings Ltd
- ZONING:** Business 3
- BUILDING AREA:**
- | | |
|----------------------|------------|
| Office and Amenities | 789.02 sqm |
| Carparks | 34 |
- ASKING RENTAL:** \$210,000 pa + GST
- OUTGOINGS:** 2018/19 budget \$36,300pa + GST, including Centre management, insurances, land rates, and other usual outgoings, but excluding consumables
- AVAILABILITY:** December 2018 (possibly earlier by negotiation)



*For further information please contact Julie Nicholson at
Quadrant Properties Ltd, Tel: 07 552 4756, 09 486 6667
Mobile: (Julie) 021 666 747*

Every precaution has been taken to establish the accuracy of the material herein. Prospective tenants should make their own inquiries to satisfy themselves on all information.

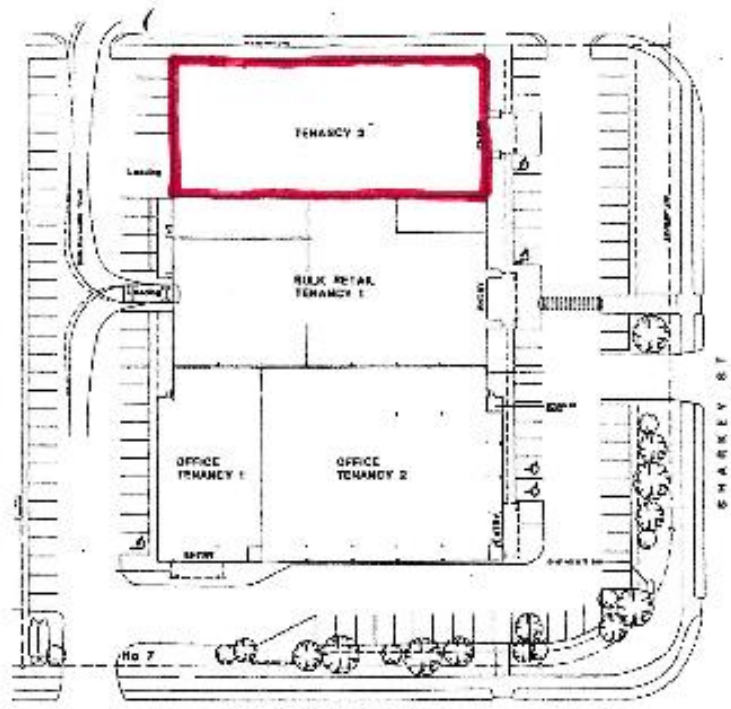

RONWOOD AVE
 DEVELOPMENT AT 7 RONWOOD AVE

SK2
 SCALE 1/400(A3)

 Tse
 ARCHITECTS

