

# TAURIKO, TAURANGA

## NEW INDUSTRIAL FOR LEASE

JUNE 2018

- ADDRESS:** 18 Whakakake Street, Tauriko, Tauranga
- Tauriko's location provides a strategic link to the Bay of Plenty and Waikato regions, between Tauranga's Port and on the direct route to Hamilton.
- DESCRIPTION:** New industrial building to be built soon. 8m stud new sprinklered warehouse measuring approx. 44 x 47m, roller doors either side of office. Large front yard on level contour.
- Great central Tauriko location and one of the closer sites to the developing Tauriko retail precinct.
- LEGAL DESCRIPTION:** Lot 77 Deposited Plan 403263 (CT's 417866)
- SITE AREA:** 3,924sqm useable land. Excellent soils report means loading issues not a problem here.
- BUILDING AREA:**
- |                     |           |
|---------------------|-----------|
| Industrial          | 2,050 sqm |
| Office & Amenities  | 215 sqm   |
| Mezzanine Storage   | 35sqm     |
| Industrial Canopies | 98 sqm    |
| Cars                | 37        |
- (subject to final consent and build)
- TENURE:** Freehold to Quadrant (Tauriko) Ltd
- ZONING:** Tauriko Business Estate – Industrial Business Activity Zone, Tauranga City Council
- INDICATIVE RENTAL:** \$300,000pa + GST and Outgoings  
(office \$220psm, warehouse \$120psm, sprinklered)
- AVAILABILITY:** Mid 2019

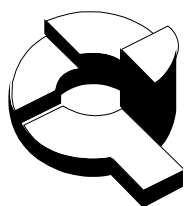

*For further information please contact Julie Nicholson or Martin Milford-Cottam  
at Quadrant Properties Ltd  
Julie Tel: 021-666-747,  
Martin Tel: 021-366-476*

Every precaution has been taken to establish the accuracy of the material herein. Prospective purchasers should make their own inquiries to satisfy themselves on all information.



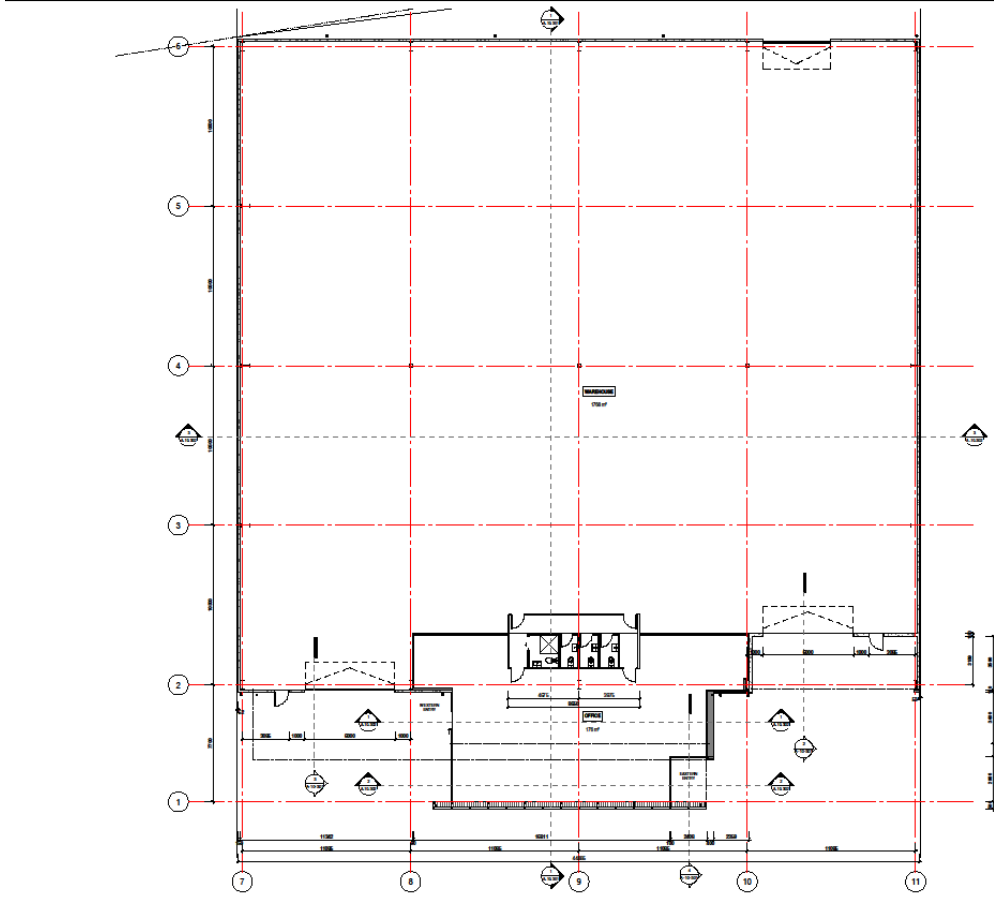

1. ALL RIGHTS RESERVED.  
 2. THIS DOCUMENT IS THE PROPERTY OF JCSW AND IS NOT TO BE REPRODUCED OR TRANSMITTED IN ANY FORM OR BY ANY MEANS, ELECTRONIC OR MECHANICAL, WITHOUT THE EXPRESS WRITTEN PERMISSION OF JCSW.  
 3. ANY UNAUTHORIZED USE OF THIS DOCUMENT IS PROHIBITED.  
 4. THE USER ACCEPTS FULL RESPONSIBILITY FOR THE ACCURACY AND COMPLETENESS OF THE INFORMATION PROVIDED.  
 5. THE USER ACCEPTS FULL RESPONSIBILITY FOR THE ACCURACY AND COMPLETENESS OF THE INFORMATION PROVIDED.

**JCSW**  
 James Cowi Structural Engineers  
 18 WHAKAKAKE ST  
 AUCKLAND, NEW ZEALAND  
 PH: +64 9 232 5400  
 FAX: +64 9 232 5401  
 WWW: WWW.JCSW.CO.NZ

CLIENT: **Quadrant (Tauriko) Ltd**  
 PROJECT: **18 WHAKAKAKE ST**  
 DRAWING NO: **FLOOR PLAN**  
 DATE: **11/10/10**  
 SCALE: **1:100**

PROJECT NO: **A-10-102**  
 PROJECT NAME: **18 WHAKAKAKE ST**